

DSX-S300BTX

SECTION 6

EXPLODED VIEWS

Note:

- -XX and -X mean standardized parts, so they may have some difference from the original one.
- Items marked "*" are not stocked since they are seldom required for routine service. Some delay should be anticipated when ordering these items.

- The mechanical parts with no reference number in the exploded views are not supplied.
- Color Indication of Appearance Parts Example:
KNOB, BALANCE (WHITE) ... (RED)

- Abbreviation
CND : Canadian model
IT : Italian model

↑ ↑
Parts Color Cabinet's Color

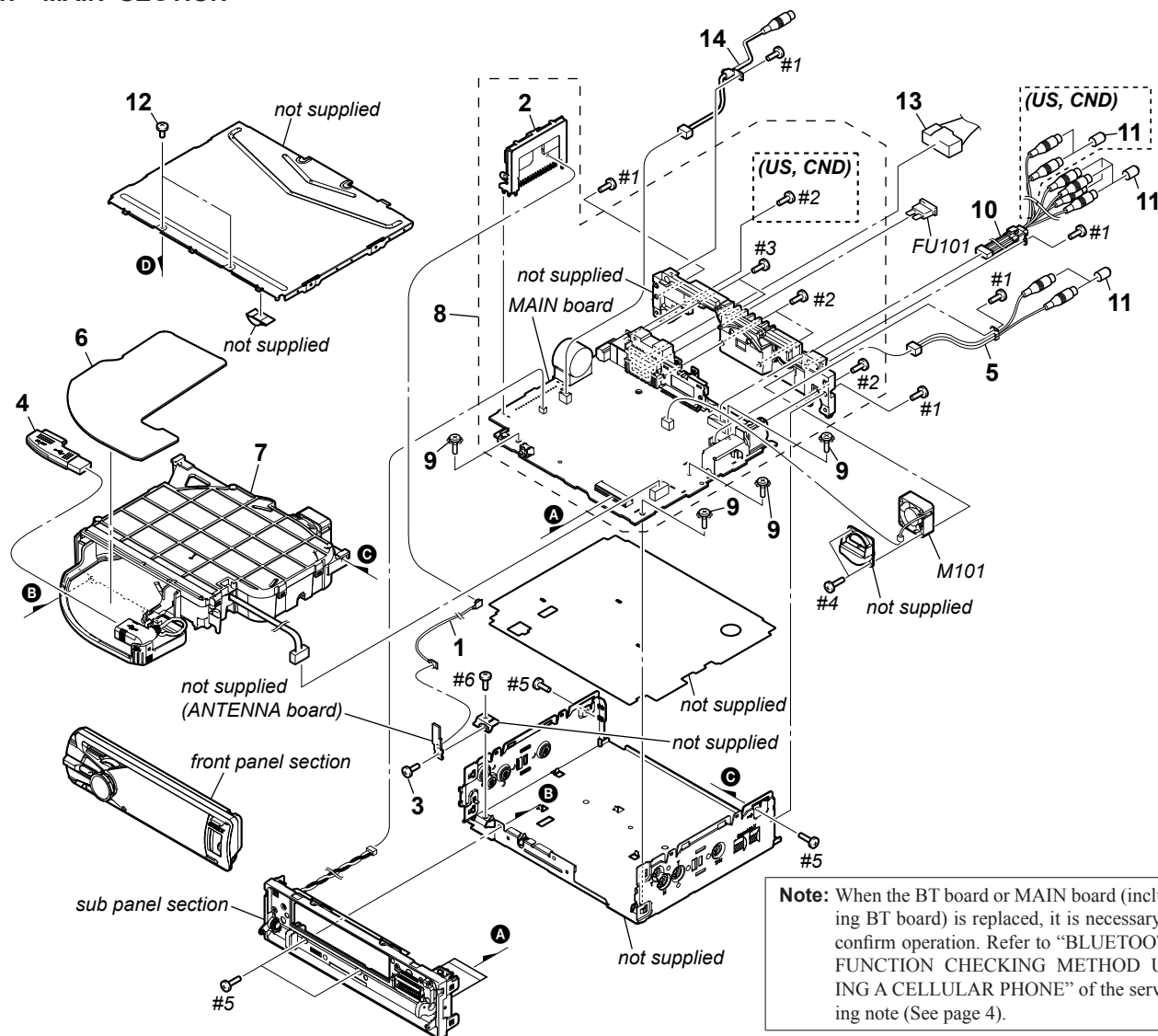
6-1. MAIN SECTION

6-2. FRONT PANEL SECTION

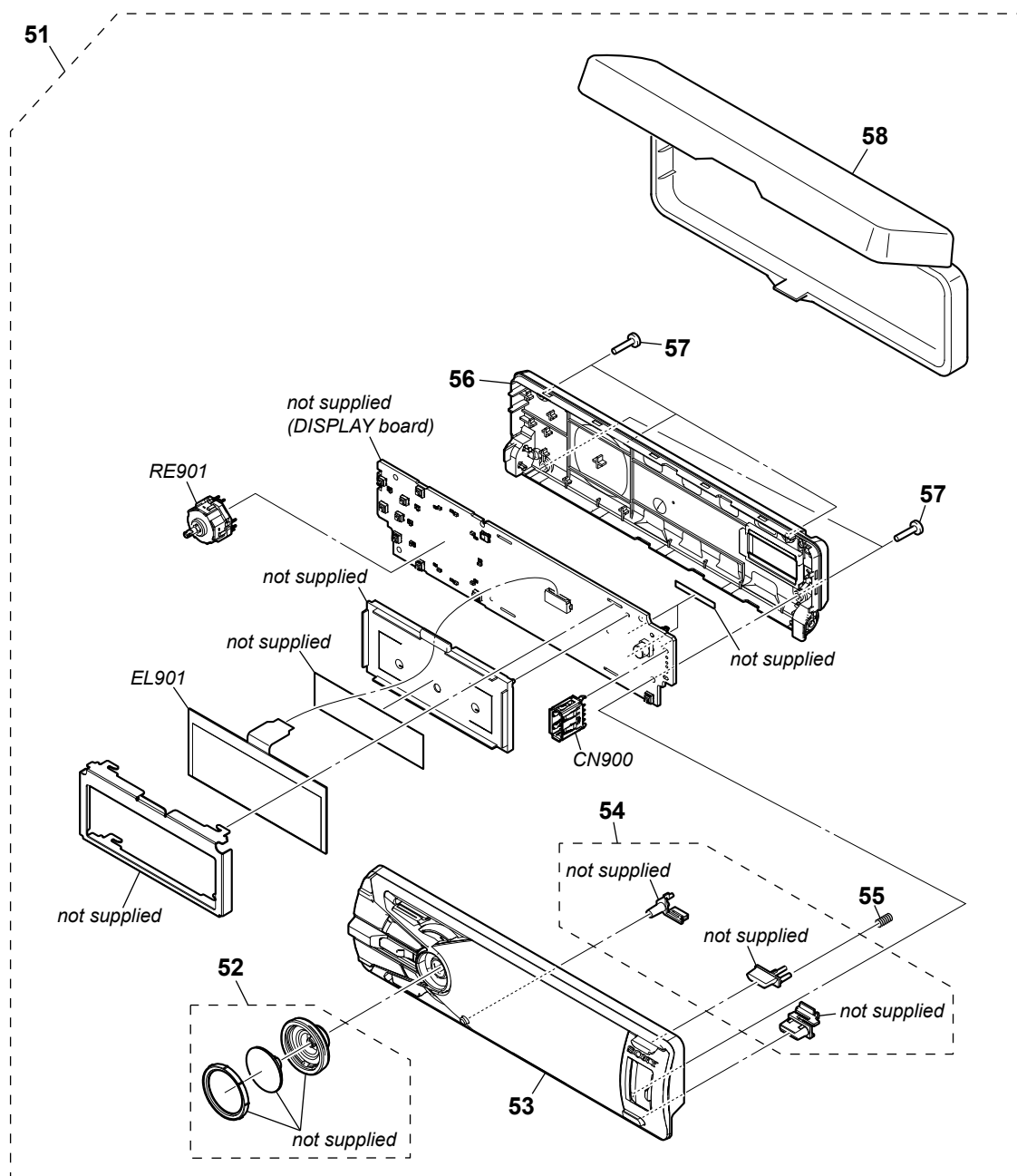

Note: Refer to the servicing notes “NOTE FOR REPLACEMENT OF THE USB CONNECTOR (CN900)” (See page 5), if replacing the Ref. No. CN900.

DSX-S300BTX

6-3. SUB PANEL SECTION

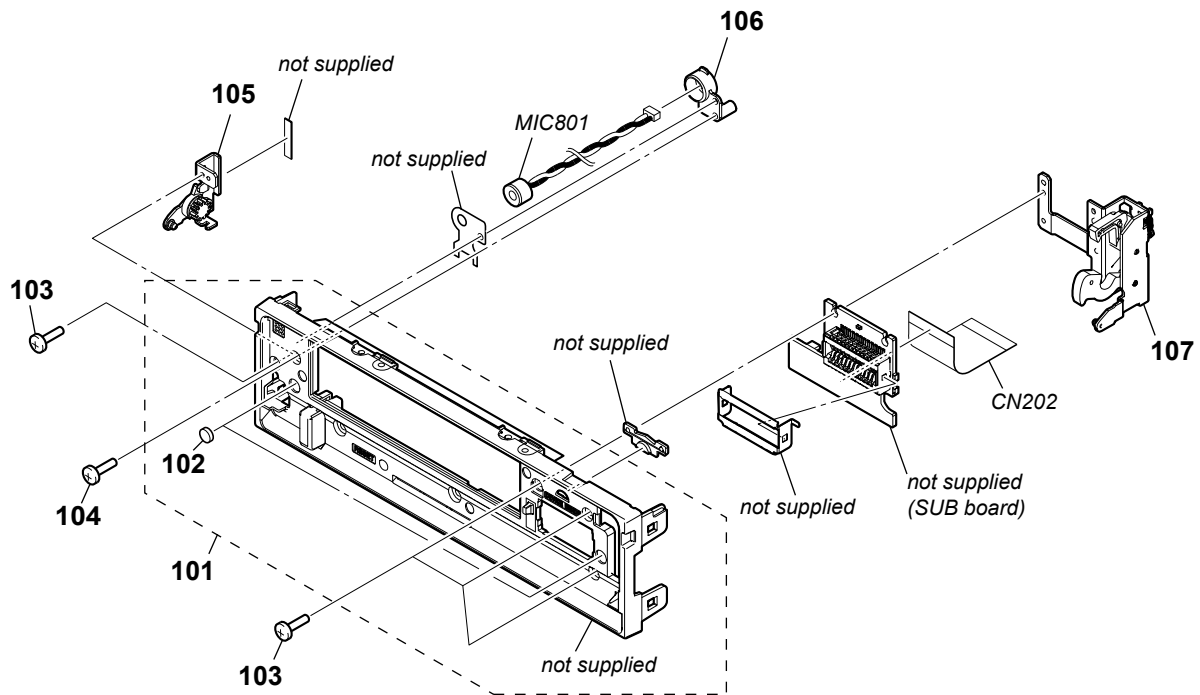

501

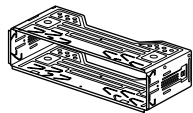

FITTING FRAME ASSY
× 1

502



KEY (FRAME)
× 2

503

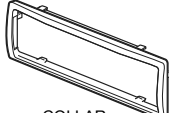

COLLAR
× 1

(AEP, IT, UK)

504

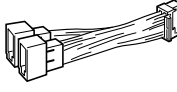

POWER CORD (ISO)
× 1

(US, CND, E)

504

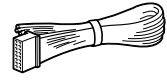

POWER CORD
× 1

(AEP, IT, UK)

505

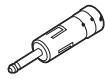

ANTENNA ADAPTER
× 1

506

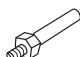

FITTING SCREW
× 1

507



BUSHING
× 1

FITTING SCREW ASSY (BS)
× 1

(E)

508

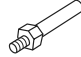

FITTING SCREW
× 1

507



BUSHING
× 1

509



+K5 × 8
× 4

FITTING SCREW ASSY (BS4)
× 1

(US, CND)

509



+K5 × 8
× 4