

Service Manual

LED TV

Model No. **TH-55AS800Z**

Chassis: LA53

Destination: NEW ZEALAND

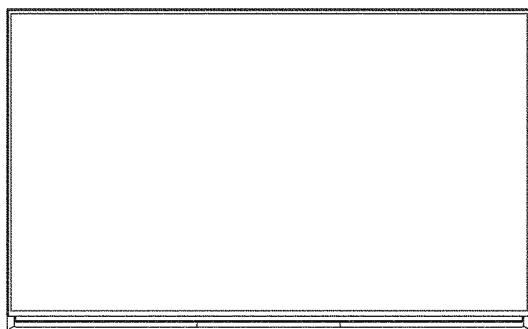

WARNING

This service information is designed for experienced repair technicians only and is not designed for use by the general public. It does not contain warnings or cautions to advise non-technical individuals of potential dangers in attempting to service a product. Products powered by electricity should be serviced or repaired only by experienced professional technicians. Any attempt to service or repair the product or products dealt with in this service information by anyone else could result in serious injury or death.

IMPORTANT SAFETY NOTICE

There are special components used in this equipment which are important for safety. These parts are marked by  in the Schematic Diagrams, Circuit Board Diagrams, Exploded Views and Replacement Parts List. It is essential that these critical parts should be replaced with manufacturer's specified parts to prevent shock, fire or other hazards. Do not modify the original design without permission of manufacturer.

TABLE OF CONTENTS

	PAGE		PAGE
1 Safety Precautions -----	3	5.1.7. Hotel Mode-----	11
1.1. General Guidelines-----	3	6 Troubleshooting Guide -----	12
1.1.1. Leakage Current Cold Check-----	3	6.1. Check of the IIC bus lines-----	12
1.1.2. Leakage Current Hot Check (See Figure 1.)-----	3	6.1.1. How to access -----	12
2 Warning -----	4	6.1.2. Self-check indication only -----	12
2.1. Prevention of Electrostatic Discharge (ESD) to Electrostatically Sensitive (ES) Devices-----	4	6.1.3. Self-check indication and forced to factory shipment setting -----	12
2.2. About lead free solder (PbF)-----	5	6.1.4. Exit-----	12
3 Service Navigation -----	6	6.1.5. Screen display -----	12
3.1. Service Hint-----	6	6.2. Power LED Blinking timing chart-----	13
4 Specifications -----	7	6.3. Method of detecting SOS -----	13
5 Service Mode -----	9	6.4. LCD Panel test mode -----	14
5.1. How to enter into Service Mode -----	9	6.5. No Power-----	14
5.1.1. Purpose -----	9	7 Disassembly and Assembly Instructions -----	15
5.1.2. Key command -----	9	7.1. Rear Panel Fitting-----	15
5.1.3. How to exit-----	9	7.2. LCD Panel Fixing & Handling Method -----	16
5.1.4. Contents of adjustment mode -----	9	7.3. Ornament Preparation -----	17
5.1.5. Display of SOS History-----	10	7.4. Screw PCB -----	18
5.1.6. Exit-----	10	7.5. Barrier Fitting-----	19
		7.6. Gasket Fitting -----	20

13 Exploded View and Replacement Parts List

Model No. : TH-55AS800Z Parts Location

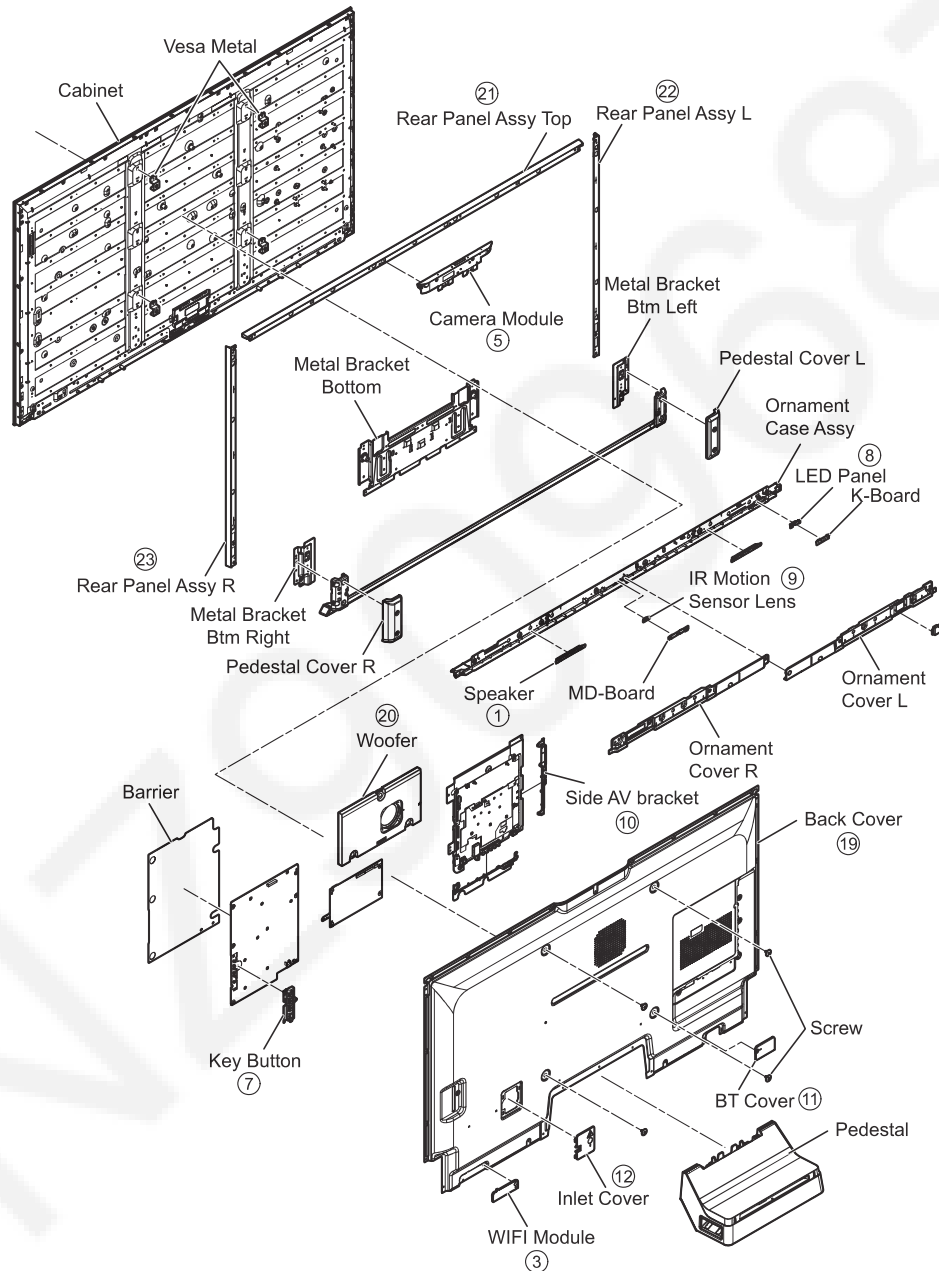

Model No. : TH-55AS800Z Packing Exploded View 1

NO	QTY	UOM	DESCRIPTION
01	1	PC	REMOTE_CONTROL
02	1	PC	CUSHION_BOTTOM
03	1	PC	SET_BAG
04	2	PC	CUSHION_BAR_ASSY
05	2	PC	CUSHION_BAR
06	0.08	MT	PAPER_TAPE_FOR_CUSHION BAR
07	2	PC	BAG_FOR_CUSHION_BAR

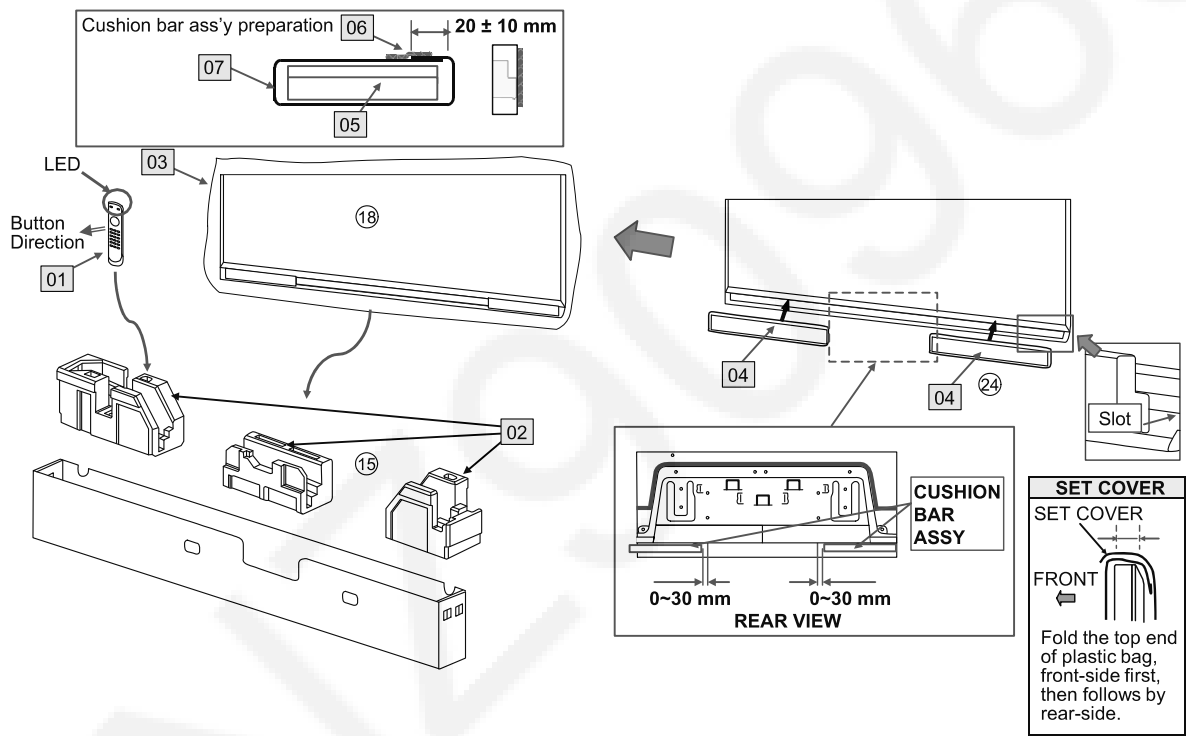

Model No. : TH-55AS800Z Packing Exploded View 2

NO	QTY	UOM	DESCRIPTION
01	1	PC	N2QBYB000027 TOUCH_REMOTE_TRANSMITTER
02	1	PC	SIDE_CUSHION_L
03	1	PC	BATTERY_PACK
04	1	PC	SIDE_CUSHION_R
05	2	PC	3D_GLASSES
06	1	MT	BATTERY_PACK
07	1	PC	PEDESTAL_ASSY
08	1	PC	CUSHION_TOP
09	1	PC	CUSHION_FRONT
10	1	PC	CORNER_CAP_ASSY

