

## SECTION 7

### EXPLODED VIEWS

**Note:**

- -XX and -X mean standardized parts, so they may have some difference from the original one.
- Items marked "\*" are not stocked since they are seldom required for routine service. Some delay should be anticipated when ordering these items.
- The mechanical parts with no reference number in the exploded views are not supplied.
- Color Indication of Appearance Parts Example:  
 KNOB, BALANCE (WHITE) . . . (RED)

↑                      ↑  
 Parts Color    Cabinet's Color

The components identified by mark  $\triangle$  or dotted line with mark  $\triangle$  are critical for safety.  
 Replace only with part number specified.

Les composants identifiés par une marque  $\triangle$  sont critiques pour la sécurité.  
 Ne les remplacer que par une pièce portant le numéro spécifié.

- The illustrations in this section are mainly that of the MEX-N5300BT. Therefore, the DAB antenna cable on the rear side of the MEX-N7300BD may be omitted in the illustrations.

#### 7-1. FRONT PANEL SECTION

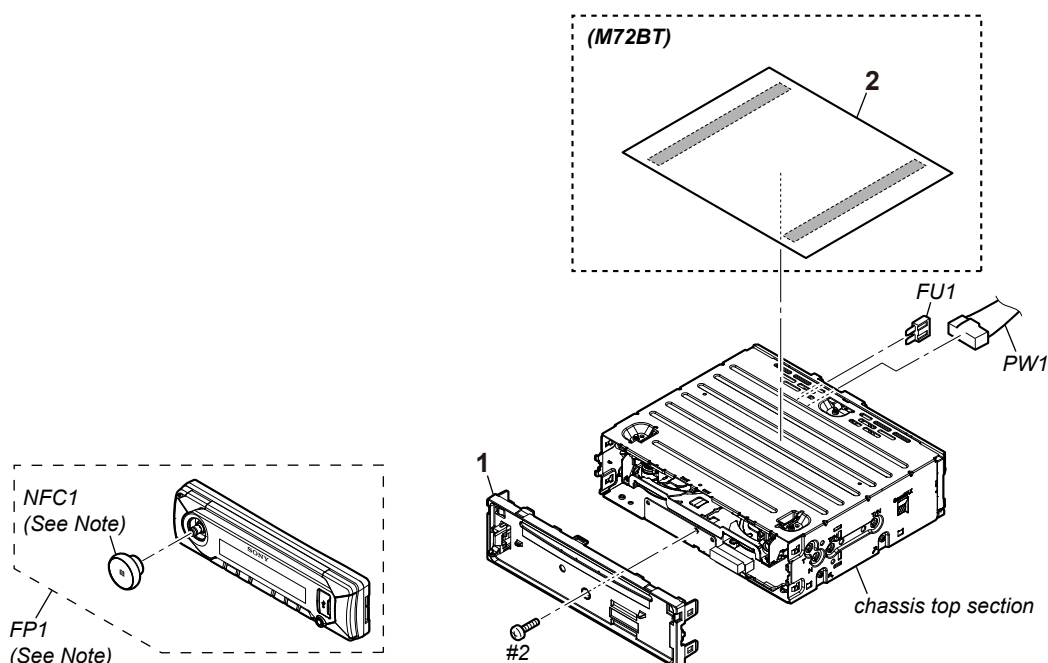

**Note:** When replacing the panel front assy (Ref. No. FP1) or knob (VOL) assy (Ref. No. NFC1), make sure to refer to "NOTE OF REPLACING THE PANEL FRONT ASSY OR THE KNOB (VOL) ASSY" on page 6.

## 7-2. CHASSIS TOP SECTION

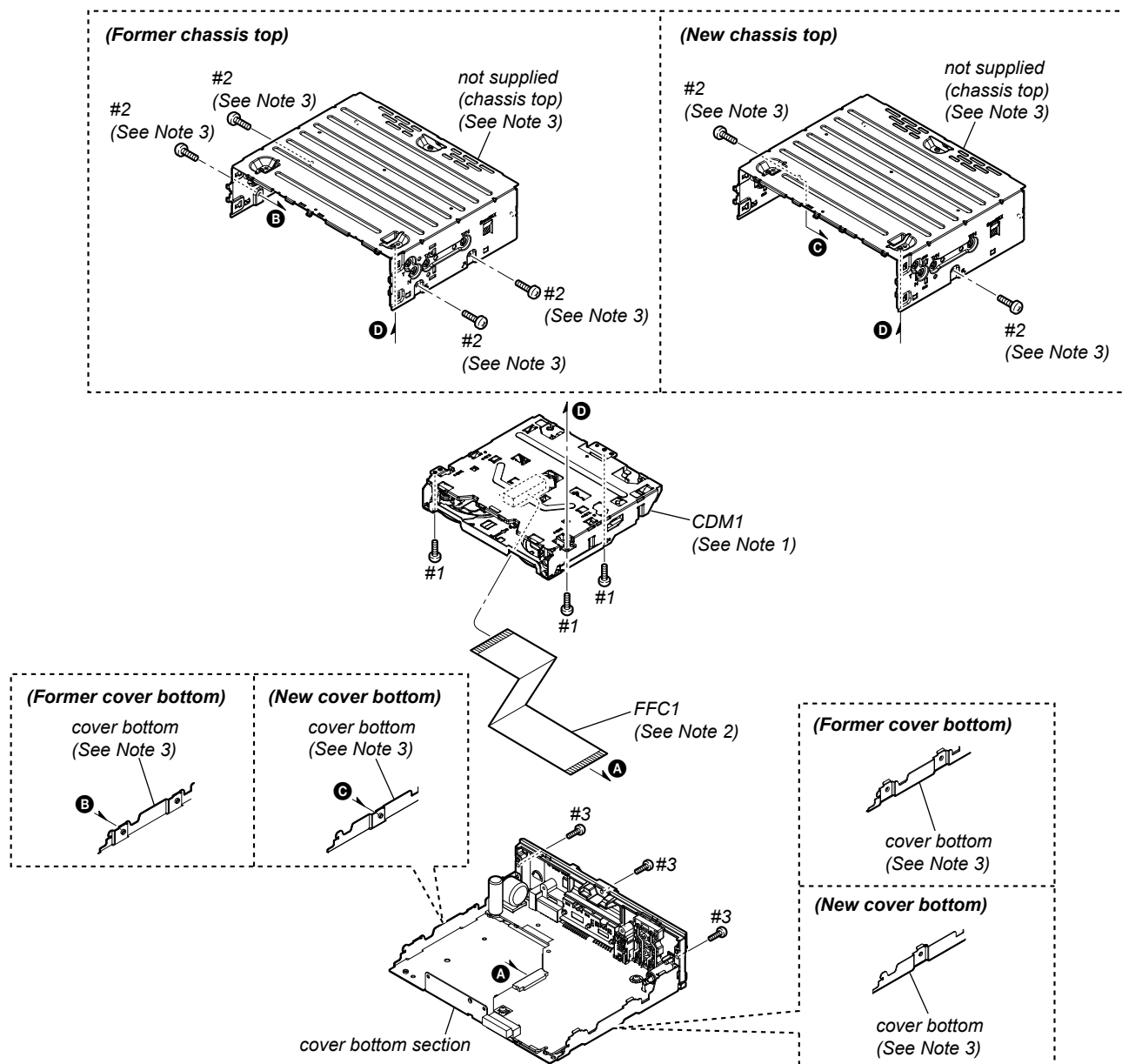

**Note 1:** When handling the CD mechatronics (Ref. No. CDM1), make sure to refer to “ABOUT THE HANDLING OF THE MECHANISM DECK” on page 10.

Also, the CD mechatronics cannot be disassembled for repair and replacement. If the internal parts or board of the CD mechatronics is malfunctioning, replace the whole CD mechatronics with a new one.

**Note 3:** The shapes of the chassis top and cover bottom were changed from the midway of production, as well as the number of screws used for those parts.

**Note 2:** Anti-static measures are required before removing the flexible flat cable (24 core) (Ref. No. FFC1) that connects the CD mechatronics (Ref. No. CDM1) and complete MAIN board (Ref. No. 52: page 67), and after installing it.

Make sure to refer to “ABOUT ANTI-STATIC MEASURES PROCESSING AT THE DETACHING/INSTALLING THE MECHANISM DECK” on page 11 and perform anti-static measures.

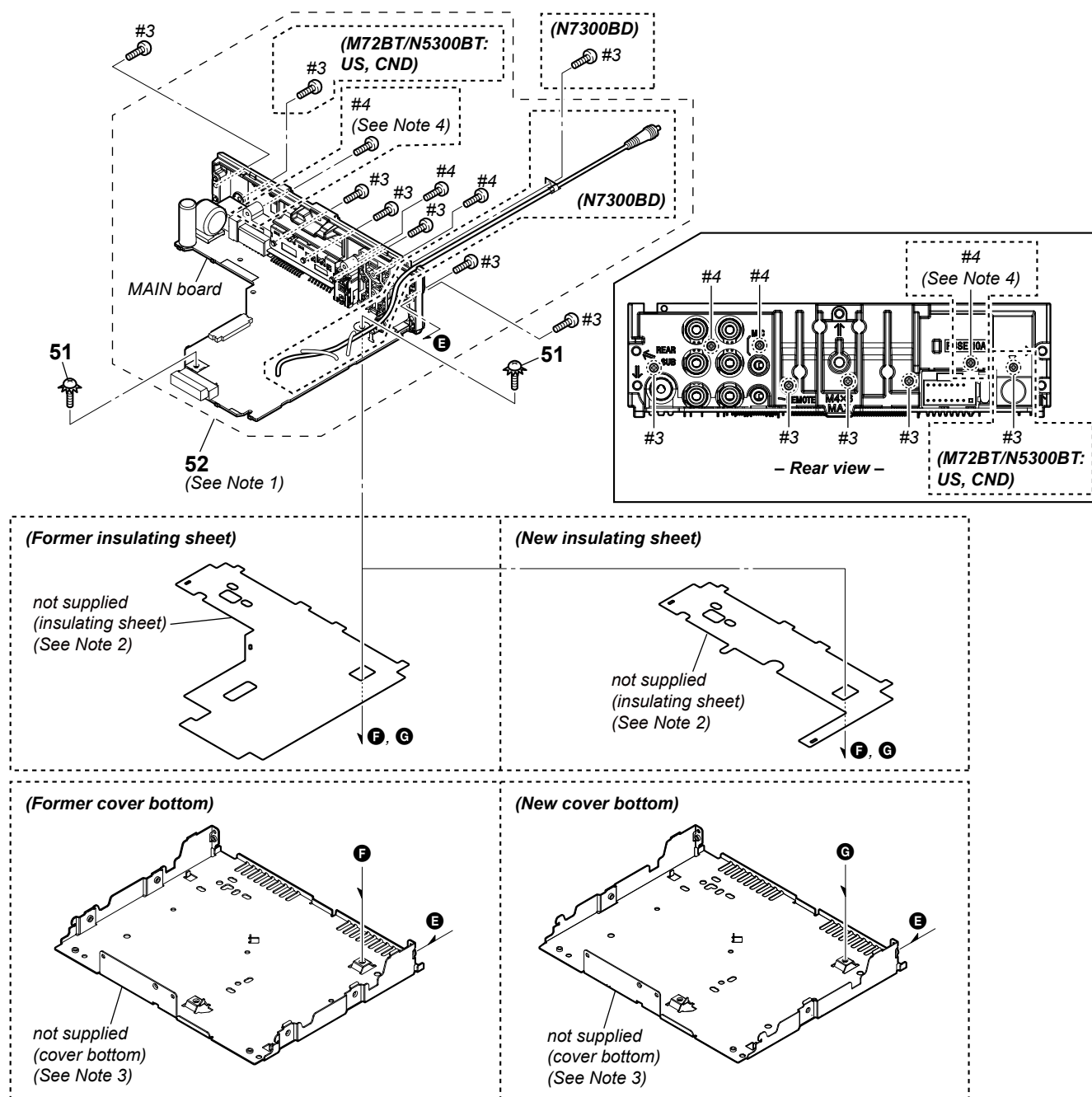
**7-3. COVER BOTTOM SECTION**

**Note 1:** When the complete MAIN board (Ref. No. 52) is replaced, be sure to replace the knob (VOL) assy (Ref. No. NFC1: page 65) simultaneously. Also, be sure to referring to “NOTE OF REPLACING THE MAIN BOARD” on page 6.

**Note 2:** The shape of the insulating sheet was changed from the midway of production. (The MEX-N7300BD has a Former insulating sheet only. It does not have a New insulating sheet)

**Note 3:** The shapes of the chassis top and cover bottom were changed from the midway of production, as well as the number of screws used for those parts. For details about the chassis top and screws, refer to page 66.

**Note 4:** One screw hole used to fasten the heat sink was deleted from the midway of production, as well as the screw used for that screw hole.