



Electrolux

ELECTROLUX HOME PRODUCTS PTY LTD

ABN 51 004 762 341

Technical Publication N° CG220.docx

Issue: 1

Date: 12/13

ELECTROLUX

GAS COOKTOPS

MODEL:

EHG953BA

PNC 943253863

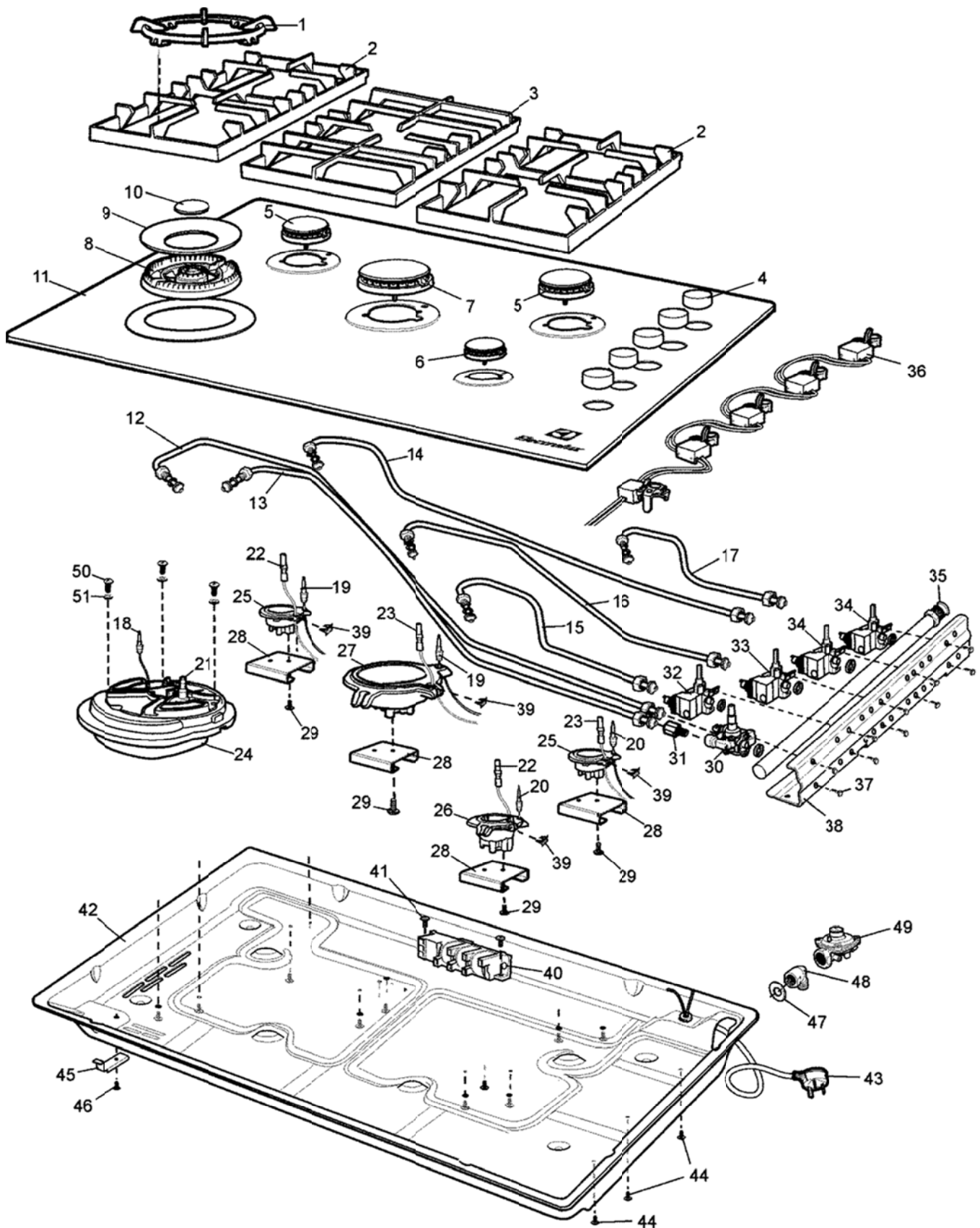

WOK BURNER "DEFENDI" DOUBLE ZONE BURNER

- 1 - Burner Caps Inner & Outer
- 2 - Burner Crown
- 3 - Thermocouple
- 4 - Spark Plug
- 5 - Burner Body

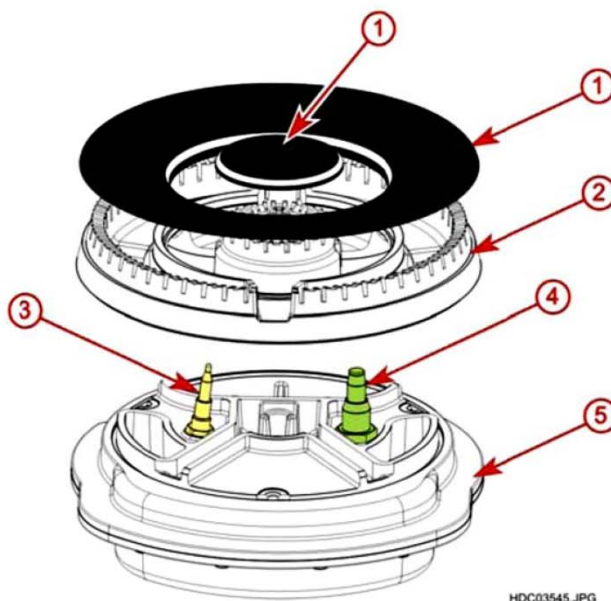

The "Defendi" double zone burner has 3 burning zones, one central and two side zones.

- 1 - Central Zone
- 2 - Left Side Zone
- 3 - Right Side Zone

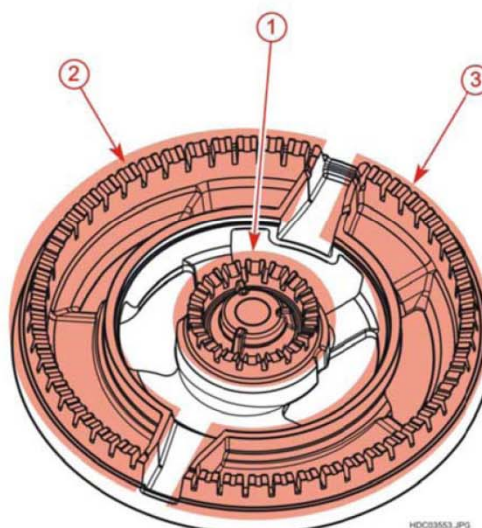

Each burner zone has its own gas supply injector. The various injectors are shown in the image below.

- 1 - Thermocouple
- 2 - Burner Body
- 3 - Blind Nozzles
- 4 - Left Side Zone Nozzle
- 5 - Central Zone Nozzle
- 6 - Right Side Zone Nozzle
- 7 - Spark Plug

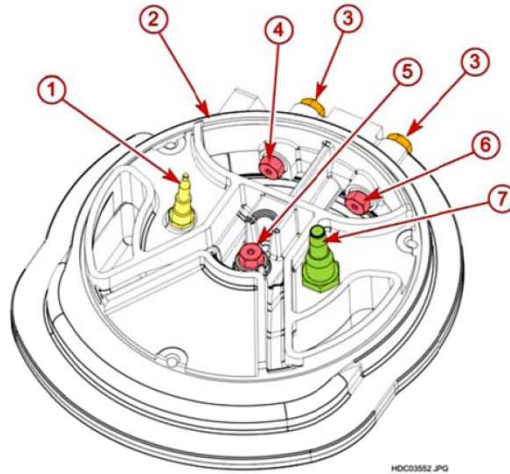

DUAL BURNER CONTROL VALVE

The dual burner control valve has two operating modes.



Rotate anti-clock wise to ignite.

Once ignited both inner and outer zones will be on full – 1, 2 & 3.



Rotate to the next icon for low with both inner and outer zones on – 1, 2 & 3.



Rotate to the last icon for low, the outer zone will extinguish and only the inner zone will be on - 3

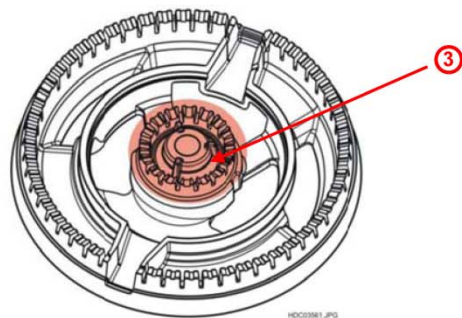
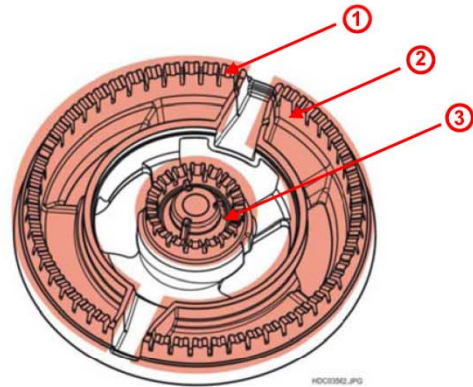
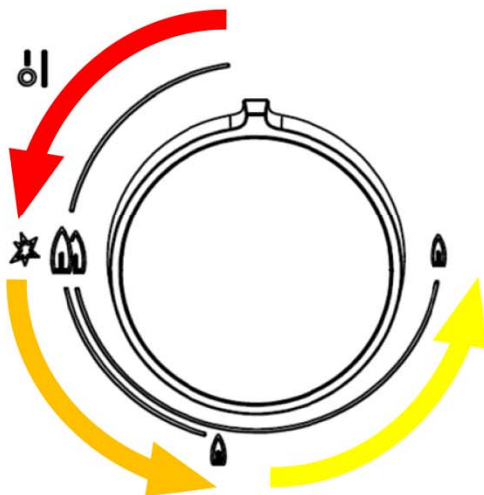

REMOVING THE INJECTORS FROM DOUBLE ZONE BURNER

1. Remove the trivets.
2. Remove the burner caps and burner crown.
3. Use a 7mm socket to unscrew and remove the centre injector.
4. Use a 7mm spanner to unscrew and remove the injectors for the outer zones.

