

Deal Drawing of the Structure and List of Parts

■ VR6340LV - BASE ASSEMBLY

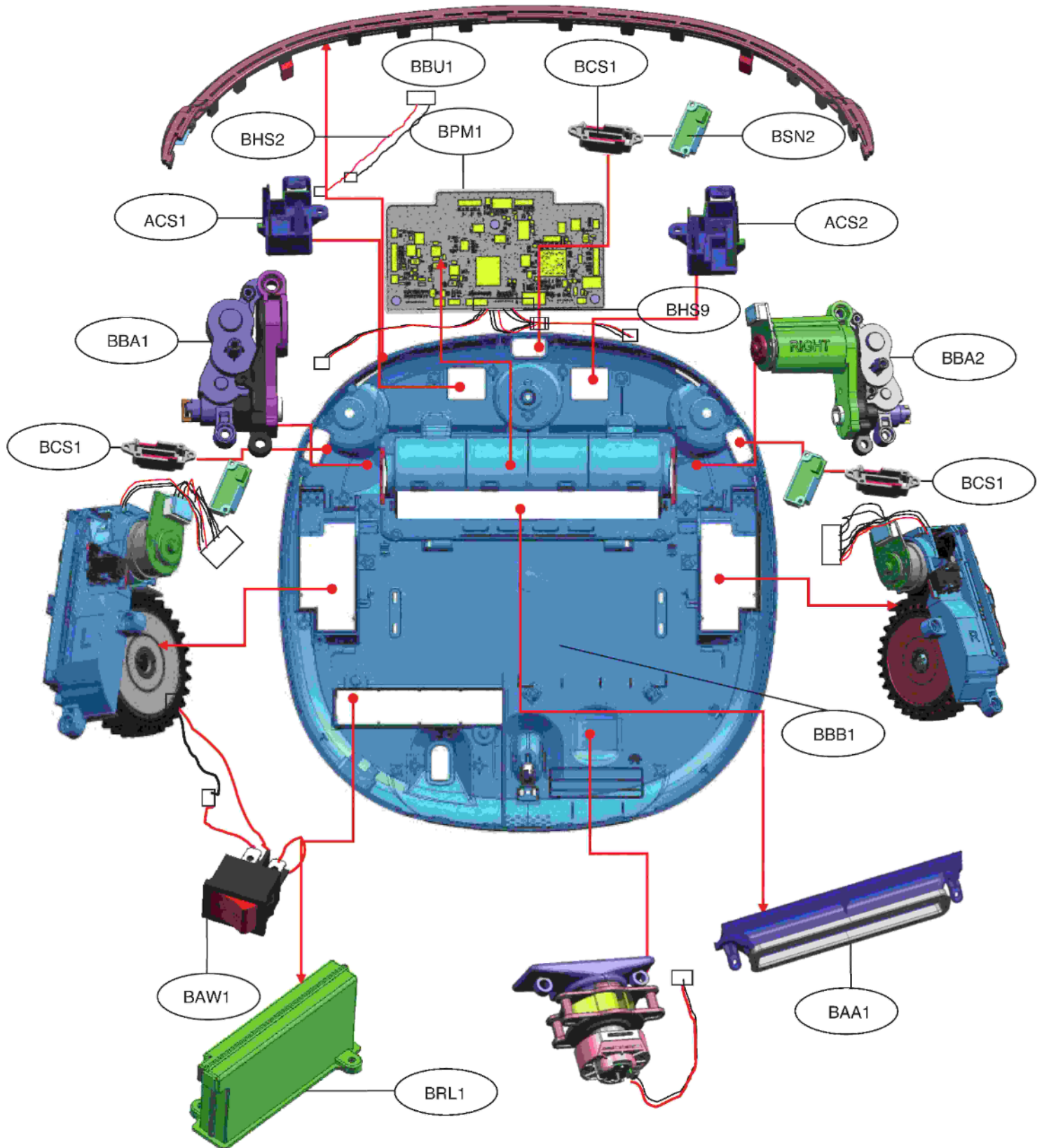

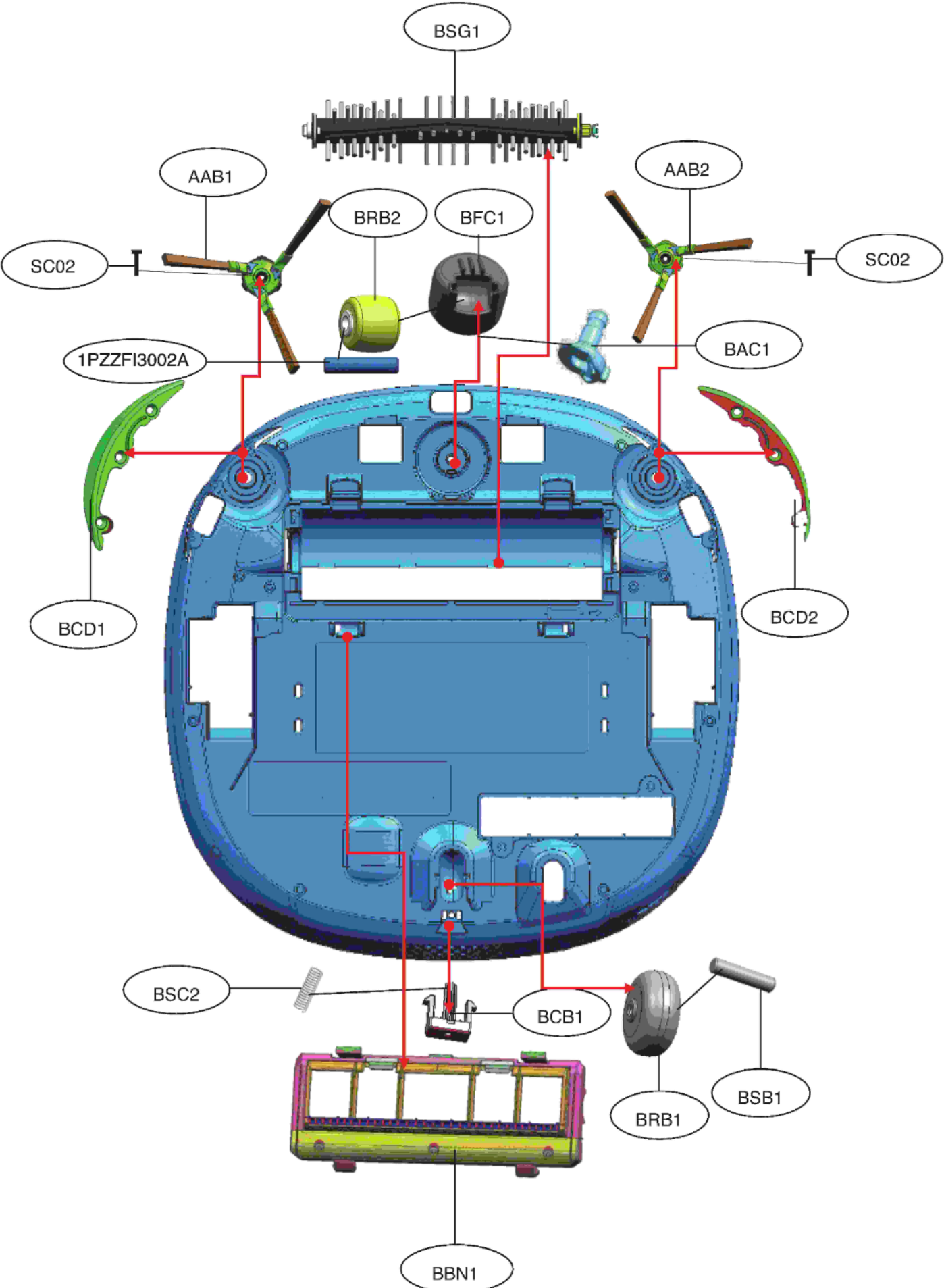

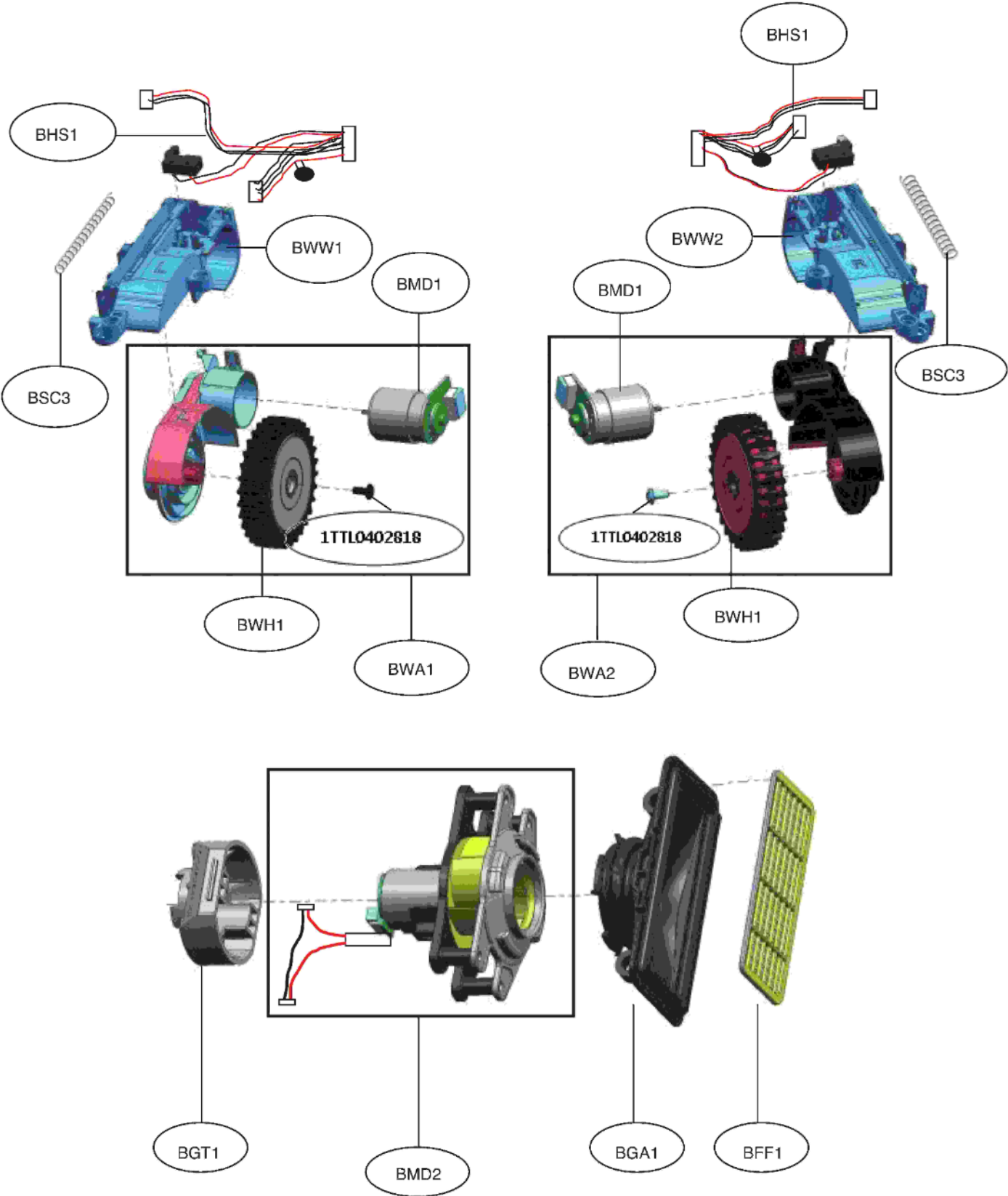

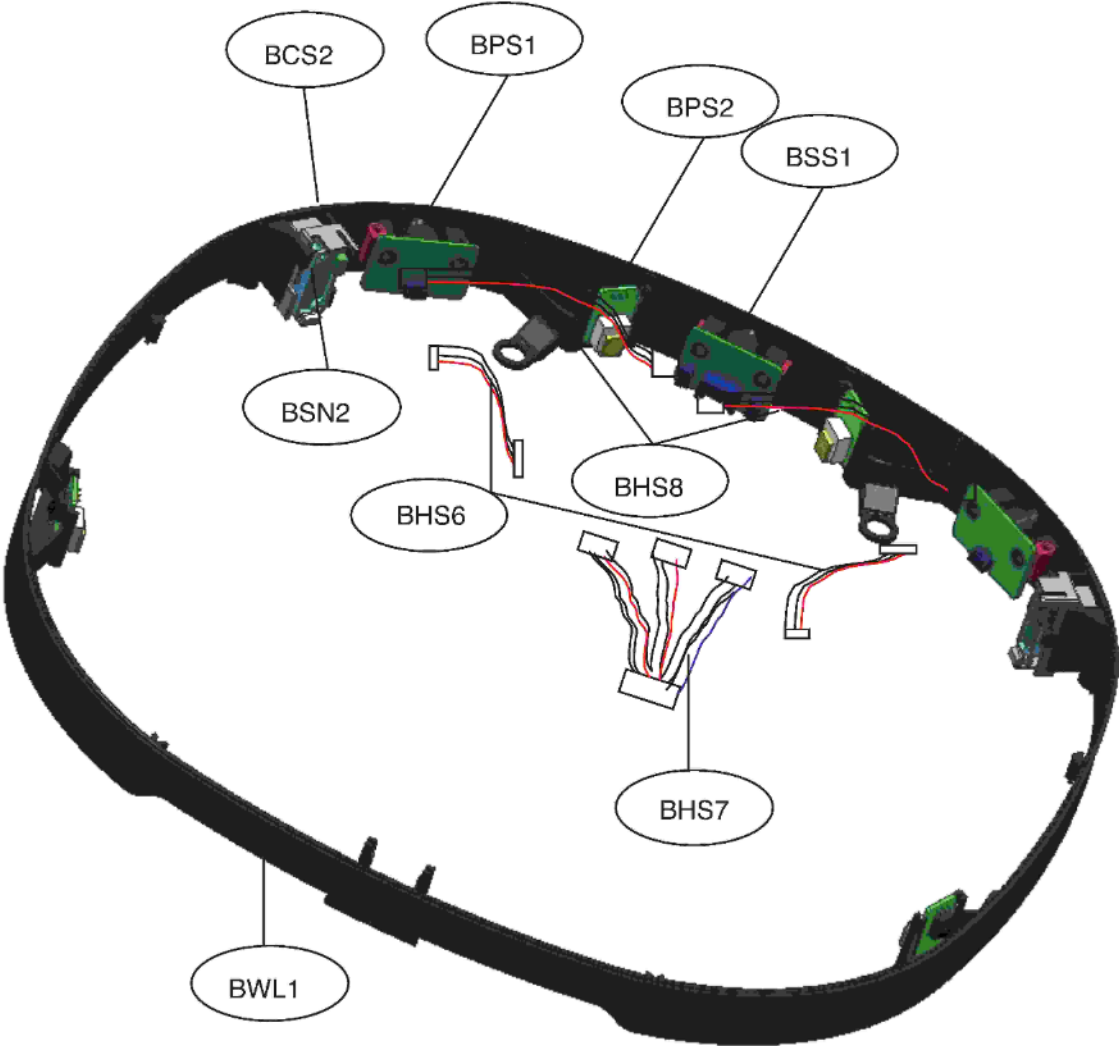

Deal Drawing of the Structure and List of Parts

■ VR6340LV - Cover Assembly

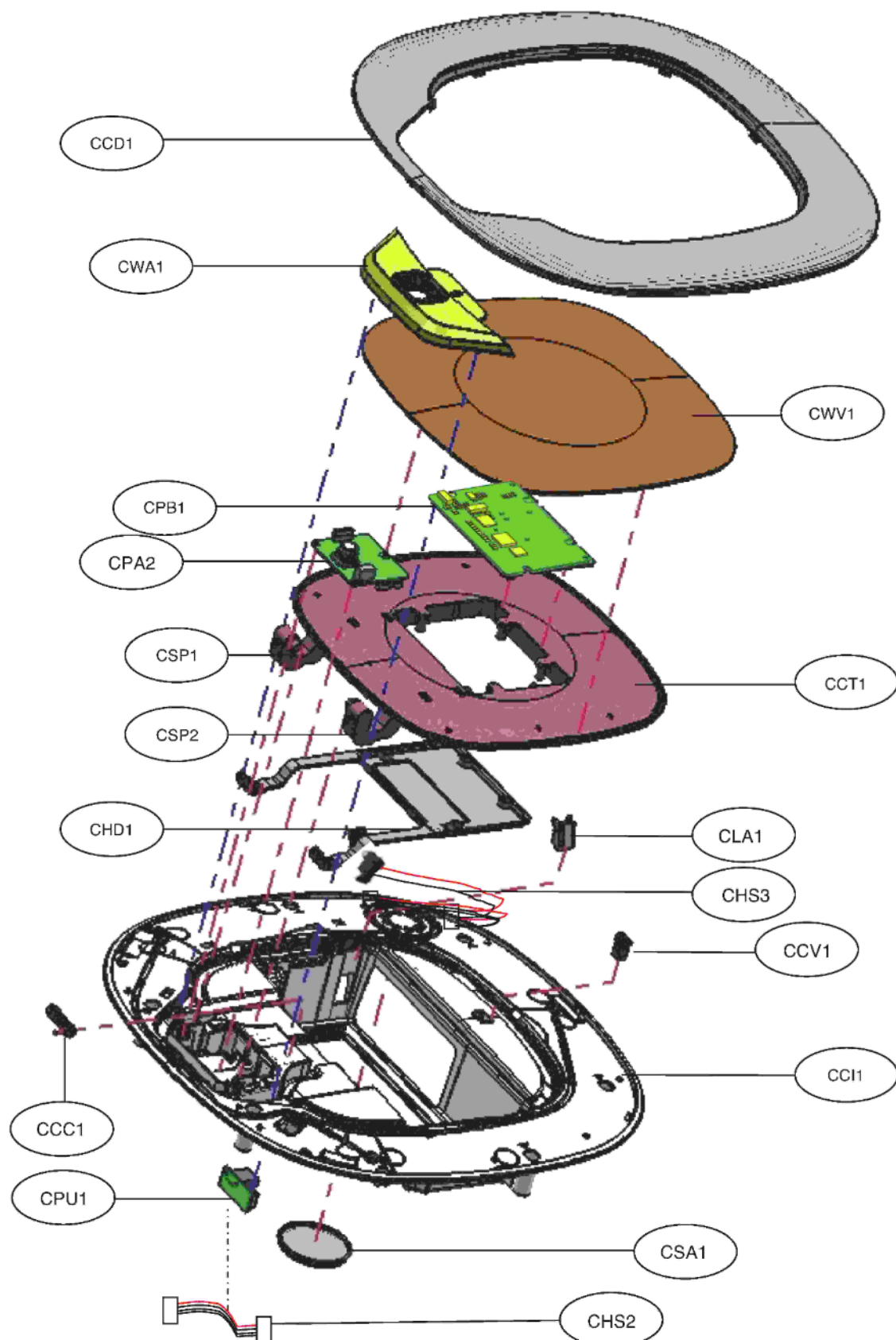

Exploded view diagram of the ABB1 device, showing the following components and their assembly relationships:

- ACB1**: Main assembly point at the top.
- AAC1**: A large black plastic housing component.
- APC1**: A power cord with a standard plug and a coiled cable.
- APG1**: A small electronic component, possibly a microcontroller or sensor.
- ABB1**: The main internal assembly, including a green printed circuit board (PCB) with various electronic components.
- ACF1**: A black plastic component, likely a filter or a part of the housing.
- AAS1**: A small, flat, rectangular component.
- ATC1**: A small electronic component, possibly a transistor or diode.
- ASC1**: A small electronic component, possibly a capacitor or resistor.
- CCP1**: A small electronic component, possibly a connector or switch.
- AHR1**: A red component, likely a relay or a switch.
- AAS2**: A small, flat, rectangular component.
- AAS3**: A small electronic component, possibly a microcontroller or sensor.
- CSW1**: A red component, likely a switch or a connector.
- APP1**: A small electronic component, possibly a microcontroller or sensor.
- AHS1**: A small electronic component, possibly a microcontroller or sensor.

Deal Drawing of the Structure and List of Parts

■ VR6340LV - Tank Assembly,Dust

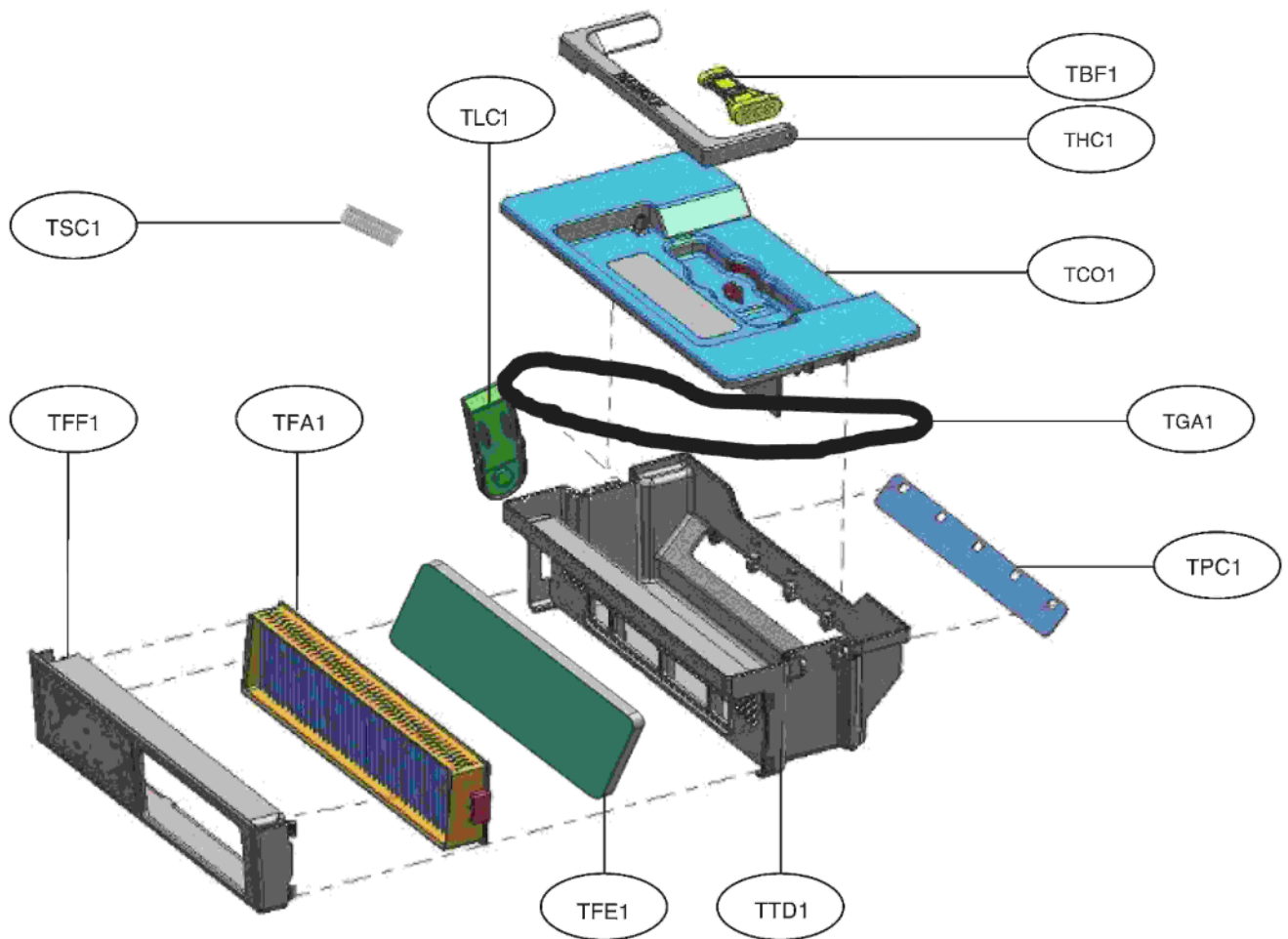

Deal Drawing of the Structure and List of Parts

■ VR6340LV - Remote Controller Assembly

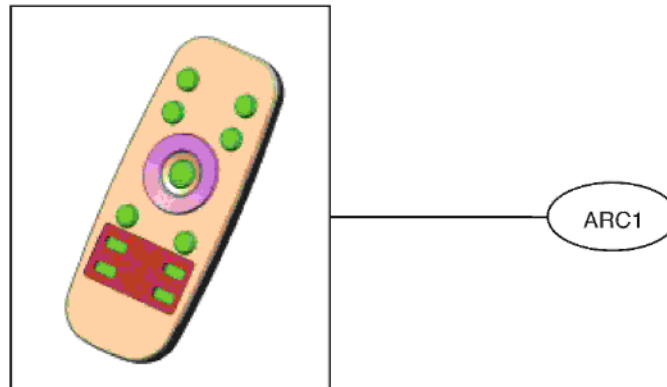

Deal Drawing of the Structure and List of Parts

■ VR6340LV - Accessory Assembly

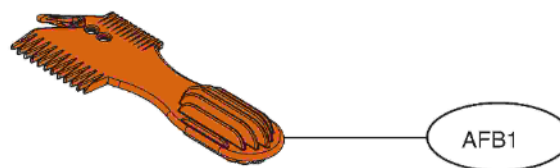

EBM61201301